

One Charles Park

11,000 s.f. for lease

Cambridge, Massachusetts



Jones Lang LaSalle is pleased to present 11,000 square feet of first class office space for lease at One Charles Park.

- Premier first class office building in East Cambridge
- Adjacent to Cambridgeside Galleria Mall and numerous restaurants, shops and hotels
- Walking distance to MBTA Red line and Green Line
- Ample parking available: 1.9/1,000 sf
- Large windows overlooking beautifully landscaped park and high ceilings
- Turn-key delivery
- Mix open space with offices and conference rooms
- On-site Bright Horizon's day care

Building size	109,427 r.s.f.
Year built	1995
SF available	11,000 s.f. on 1st floor
Parking	1.9 spaces per 1,000 s.f. located in the adjacent Rogers Street Garage

One Charles Park

11,000 s.f. for lease

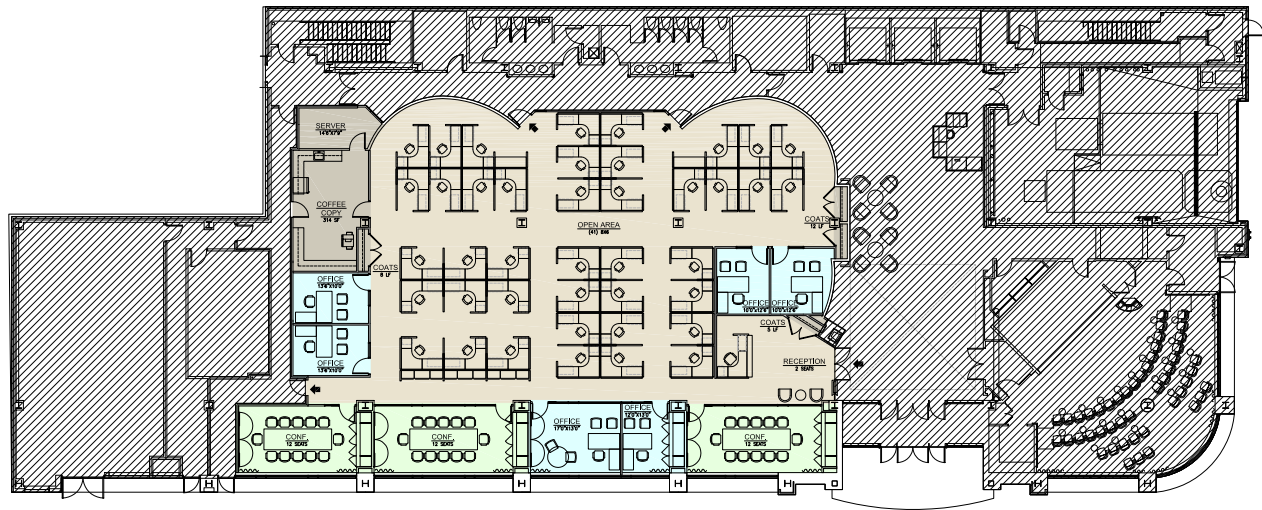

First floor plan

Pete Bekarian
+1 617 531 4231
Peter.Bekarian@am.jll.com

Emilie Gullans
+1 617 531 4231
Emilie.Gullans@am.jll.com

Molly Heath
+1 617 361 6489
Molly.Heath@am.jll.com



**JONES LANG
LASALLE**

One Post Office Square Boston, MA 02109